



ACCESSORIES

BERMUDA CLIP

\$ EACH

FASTENERS PER THOUSAND

#10 x 1" ACQ PANHEAD QUAD DRIVE.	\$
#10 x 1" PANHEAD SELF DRILLER.	\$
#10 x 1" COL.	\$
#10 x 1.5" COL.	\$
#14 x 1.25" COL.	\$
#14 x 7/8" STITCH COL.	\$

LENGTH: 5' - 26'

STANDARD PROFILE WEIGHTS:

24ga - 1.33 lbs. / LINEAL FT.

22ga - 1.67 lbs. / LINEAL FT.

OIL-CANNING IS A PHENOMENON THAT CAN OCCUR ON FLAT METAL AND IS NOT A JUST CAUSE FOR MATERIAL REJECTION.

CONSULT YOUR SALES REP FOR BEST INSTALLATION PRACTICES

NOTE:
VARIABLE PLANK LENGTHS MUST BE ORDERED IN MULTIPLES.

VP-12" MULTIPLES OF 3
VP-8" MULTIPLES OF 4
VP-4.5" MULTIPLES OF 5

VARIABLE PLANK

MAY, 2024

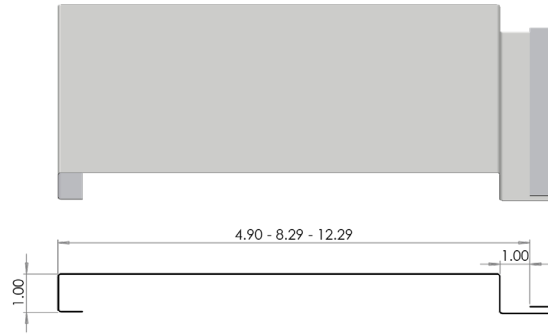

SMP COLORS & GAUGES (SEE NET PRICE PAGE)

Polar White - 24, 22	Cashmere - 24, 22	Slate Blue - 24, 22
Cambridge White - 24, 22	Antique Linen - 24	Sapphire Blue - 24
White White - 24, 22	Wicker - 24	Mist Green - 24
Brite White - 24	Briarwood Tan - 24	Sage Green - 24
Bone White - 24, 22	Tan - 24, 22	Turquoise - N/A
Surf White - 24, 22	Buckskin - N/A	Pacific Turquoise - 24
Stone Grey - 24, 22	Gold - 24	Deep Water Green - 24
Regent Grey - 24, 22	Sportsman Yellow - N/A	Forest Green - 24
Pebblestone - N/A	Brite Red - 24	Spruce Green - 24
Charcoal Grey - 24, 22	Dark Red - 24	Melchers Green - 24
Black - 24, 22	Tile Red - 24	Dark Green - 24
Black Coffee - 24	Burgundy - 24	Iron Ore - 24, 22
Metro Brown - 24, 22	Labrador Blue - 24	Brite Green - N/A
Dark Brown - 24, 22	Heron Blue - 24	Int. Orange - 24
Ivory - N/A	Royal Blue - 24	

SMP TEX™ COLORS & GAUGES (SEE NET PRICE PAGE)

Burnished Slate - 24	Kona Brown - 24
Graphite - 24	Black Onyx - 24

PVDF COLORS & GAUGES (SEE NET PRICE PAGE)

Regal White - 24, 22	Terra Cotta - 24, 22	Twilight Blue - 24
Parchment - 24, 22	Colonial Red - 24	Tahoe Blue - N/A
Sierra Tan - 24	Retro Red - 24	Regal Blue - 24, 22
Champagne Metallic - 24, 22	Hemlock Green - 24	Weathered Zinc - 24, 22
Mocha - 24	Dark Green - N/A	Old Town Grey - 24, 22
Weathered Copper - 24	Forest Green - 24	Old Zinc Grey - 24, 22
Bronze - 24	Hartford Green - 24	Slate Grey - 24, 22
Dark Bronze - 24, 22	Low Gloss Black - 24, 22	
Copper Penny - 24, 22	Silver Metallic - 24, 22	

PRINTED COLORS & GAUGES (SEE NET PRICE PAGE)

PVDF	PVDF	PE
Acorn - 24	Frontier - 24	Ashwood - 24
Aged Copper - 24	Gunstock - 24	Concrete - 24
Autumn - 24	Homestead - 24	Corten - 24
Barn Board - 24	Light Zinc - 24	Knotty Pine - 24
Birch - 24	Ponderosa - 24	Light Pine - 24
Canyon - 24	Rustic Red - 24	Mesquite - 24
Dark Zinc - 24	Saddle - 24	
Durango - 24	Wagonwood - 24	
Espresso - 24		

PLAIN/INTERIOR STOCK & GAUGES

Interior Liner Brite White - N/A	Galvanized/Galvalume - N/A
----------------------------------	----------------------------

TERMS Net 30 Days. Prices subject to change without notice.

www.westform.com

RECOMMENDED FLASHINGS

ROOF FLASHINGS WILL BE 4/12 PITCH UNLESS OTHERWISE SPECIFIED

<p>STARTER CLEAT CLEAT</p> <p>3/4" 1/2" 2" 4"</p>	<p>WALL BASE 636DC</p> <p>BENT AT 5° SLOPE</p> <p>3-1/4" 1-3/4" 1/2" 6"</p>	<p>HEADER 636HD</p> <p>BENT AT 5° SLOPE</p> <p>COLOR 2 SIDE</p> <p>3" 1-3/4" 1/2" 1-1/2" 1-3/4" 9"</p>	<p>WALL TRANSITION CORWT</p> <p>3-3/8" 1-1/8" 1" 6"</p>
---	---	--	---

<p>J TRIM 2 PRJT2</p> <p>COLOR 2 SIDE</p> <p>3" 1" 1-1/8" 1/2" 9"</p>	<p>EZLOK J 1" EZJ1</p> <p>ASSEMBLED</p> <p>1-1/2" 1/2" TOP CAP 2" BASE</p>	<p>EZLOK T 1" EZT1</p> <p>ASSEMBLED</p> <p>2" TOP CAP 1/2" 4" BASE 9"</p>	<p>1/S CORNER CAP CORICC</p> <p>EXPOSED FASTENER CORNER</p> <p>1/2" 4" 4" 9"</p>
---	---	---	--

<p>Q/S CORNER CAP CORCCH</p> <p>EXPOSED FASTENER CORNER</p> <p>1/2" 1/2" 4" 9"</p>	<p>1/S CORNER QLIC1</p> <p>HIDDEN FASTENER CORNER</p> <p>NON-ASSEMBLED</p> <p>1-1/2" 1-1/2" 2-1/2" 1-1/2" 1-1/2" 2-1/2"</p>	<p>Q/S CORNER QLOC1</p> <p>HIDDEN FASTENER CORNER</p> <p>NON-ASSEMBLED</p> <p>1-1/2" 1-1/2" 3" 2-1/2" 1-1/2" 1-1/2" 3"</p>	<p>L TRIM CORLT</p> <p>2-1/2" 1" 4"</p>
--	--	---	---

<p>J TRIM VENTED HFJTV</p> <p>1/2" 1-5/8" 1/2" 2-3/8" 1-1/8" 9"</p> <p>BASE 22GA GALV PERF. CAP MATCHING PROFILE COLOR</p>			
--	--	--	--

<p>#12 STITCH SCREW S12S100(color)</p>	<p>#10 PANHEAD DRILLER S10PD100GA</p>	<p>#10 ACQ PANHEAD S12T100ACQ</p>	<p>2" BERMUDA WALL CLIP HF-CLIP</p> <p>SCREWS NOT INCLUDED</p>
---	--	--	---

WIDTH	GALV / LUME 26 GAUGE	SMP 26 GAUGE	PVDF/TEX 26 GAUGE	GALV / LUME 24 GAUGE	SMP 24 GAUGE	PVDF/PRINTECH/TEX 24 GAUGE
4"						
6"						
9"						
12"						
15"						
18"						
24"						
EZJ1						
EZT1						
QLIC1						
QLOC1						

TERMS NET 30 DAYS. PRICES SUBJECT TO CHANGE WITHOUT NOTICE.