

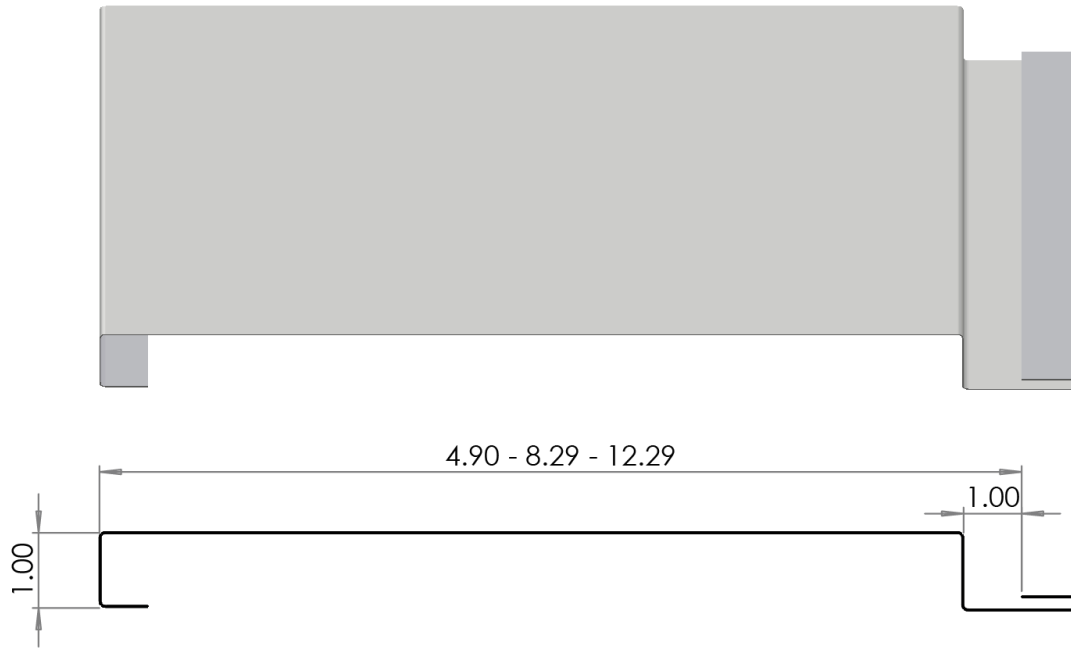

# VARIABLE PLANK Installation Guide



## Profile



## Standards

Variable Plank sheet steel cladding shall be manufactured in accordance to:

- CSSBI 23M-2016 Standard for Residential Steel Cladding
- CSSBI 20M-2017 Standard for Sheet Steel Cladding for Industrial, Commercial and Institutional Building Applications

## Fastening

Variable Plank is fastened to the wall with the use of an adjustable floating clip system.

- Spacing: Max. 24" unless specified by an engineer  
Fasteners: #10 ACQ Panhead(Wood)  
              #10 Panhead Driller(Metal)  
              Not included with clip

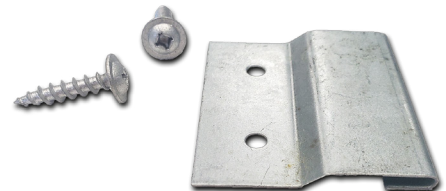

## Material Preparation

Remove any protective film from panels as well as flashing trims. Leaving film for an extended time exposed to the sun/UV light will increase the difficulty of removing the protective film. Best practice for removing film is to start at one end peeling back the tape until the profile is free. Continue to peel film at a low angle in a steady motion. Removing at a high angle and applying too much pressure will tear the film.

## Storage

Storage time should be minimized by installing the cladding panels as soon as possible after delivery. Good planning will ensure that panels are used on a first-in first-out basis. If cladding must be stored for an extended period, the most desirable storage place is under-roof in a cool, dry, well ventilated area. When storing outdoors is unavoidable, the following is recommended:

- (1) use good covers, loosely shrouded over stacks and firmly anchored to prevent wind blow off, but plastic covers should not be used for storage
- (2) tilt bundles for drainage
- (3) ventilate bundles but do not allow entry of wind-driven rain
- (4) block bundles off the ground for effective drainage and ventilation
- (5) block long panels to prevent sagging
- (6) store out of direct sunlight if possible
- (7) store away from chemically aggressive substances (e.g. salt, cement, fertilizer), away from material that could contaminate the surface (e.g. diesel oil, paint, grease) and away from site traffic.

Shipments of bundled cladding panels should be inspected upon delivery. Moisture can cause wet storage staining of prefinished material and usually occurs in one of three ways:

- (1) condensation from high humidity and/or temperature cycling.
- (2) wet shipping conditions.
- (3) wind -driven rain penetration (outdoor storage). The usual progression is from visible water staining to unsightly white staining (dark grey to dull black on aluminum zinc alloy coated material) to red rust. On material where wet storage staining has occurred, it should be noted that nominal amount of white staining is not detrimental to the functioning of the product and is usually considered acceptable.

For further information on care and maintenance refer to: **CSSBI SSF 03-17 Fact Sheet**

## Cutting Cladding

Variable Plank recommended cutting options:

- (1) A circular saw with a cross cut jig and appropriate blade for sheet steel materials
- (2) Rip cuts with power hand shears/nibblers
- (3) Aviation hand snips

**An abrasive disk blade with a angle grinder or power saw is NOT recommended.**

Circular Saw with  
cross cut jig

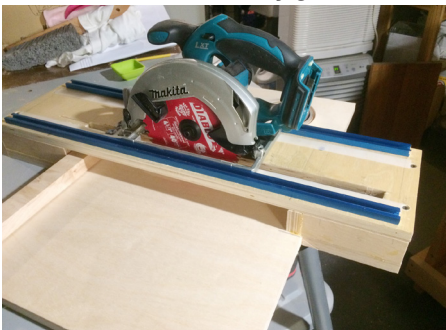

Power Hand Shears



Aviation Hand Snips



## Installation Precautions

### Pressure Treated Wood

It is recommended that all galvanized or painted sheet steel roofing or siding products be separated from ACQ pressure treated wood with Ice & Water Shield membrane or similar product. The use of roofing felts is not an adequate separator. For more information on sheet steel products and pressure treated wood refer to **CSSBI SSF 18-10 Fact Sheet**

### Handling

Remember to always use leather faced gloves when handling metal cladding and trims. Also, if using a saw to cut prepainted sheets, make sure that the painted surface is protected because the hot filings will damage the paint finish.

### Personal Protection

The erector's employees shall wear such personal protective clothing, equipment or devices as deemed necessary for the individual's protection from the particular hazards associated with the installation of steel products. This equipment should include, but is not limited to, safety hats, safety belts, safety footwear, eye protection and gloves.

## Details

Attached are typical standard installation details. It is the responsibility of the installer to follow all provincial, regional and municipal building codes.

Substrate plane must be level and plumb. Non-level/plumb planes can introduce stresses on the panel resulting in a wavy appearance.

## Underlay

Install wall underlay as per manufacturers recommendations.

## Panel Layout

**(A)** Using a chalk line, layout a level horizontal line around the project walls.

**(B)** Chalk a vertical plumb line on each wall using the 3-4-5 square method from the horizontal line.

**Note:** It is common practice to layout panel orientation from the back of the wall section working towards the front of the building. This way the lap edge of the panel connection is facing the back of the project creating a cleaner appearance from the front of the building.

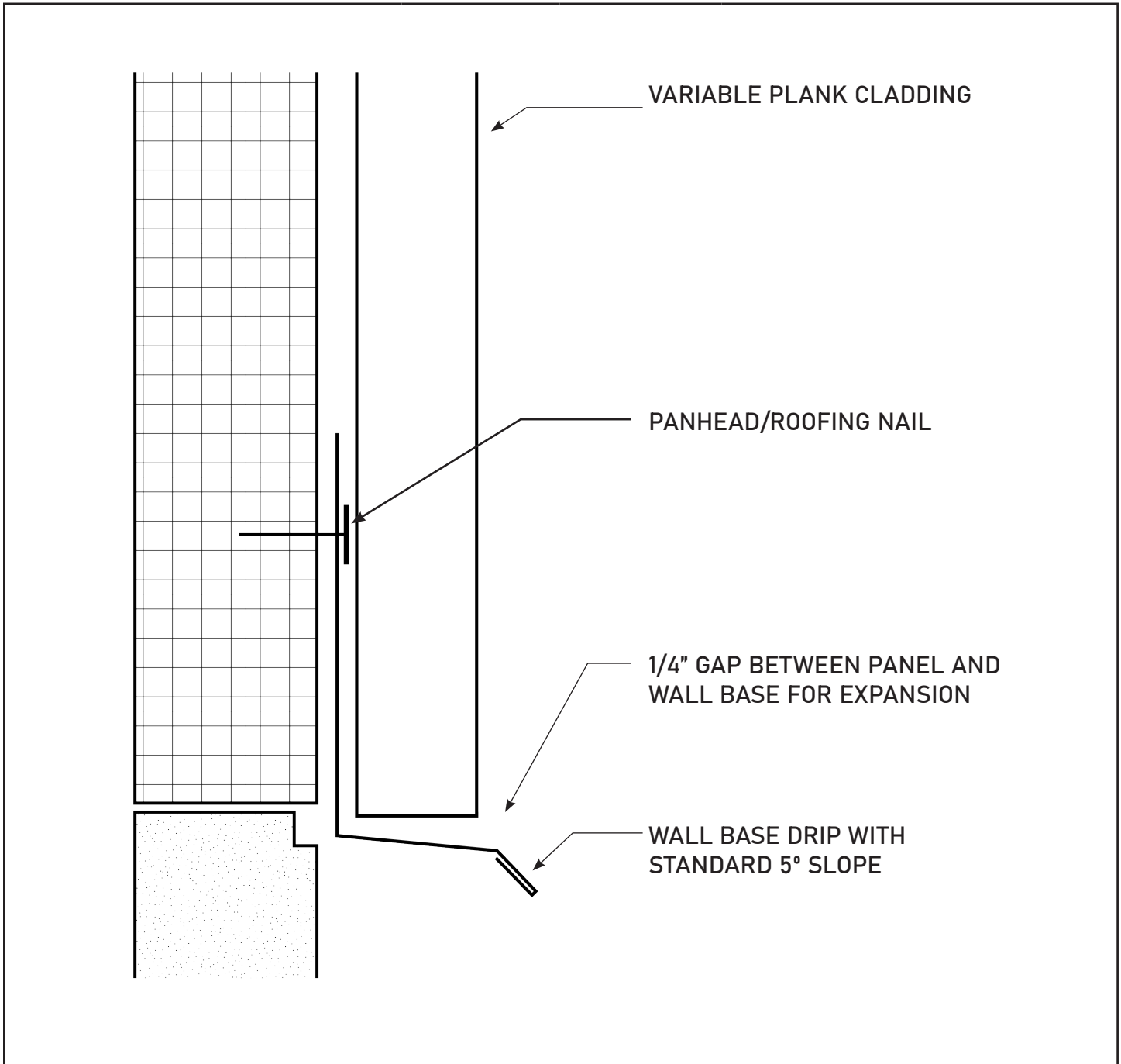

**Notes:**

- Detail is not to scale.
- Wall plane must be level and plumb.
- Fastening clip recommended spacing is 24" on center.
- It is the responsibility of the installer to follow all applicable building codes.
- If J trim is to be used for top and bottom of panel it is recommended to use a EZLOK J for one side to fit in the panel.

WALL BASE DRIP FLASHING	VP-1	2023	WESTFORM METALS VARIABLE PLANK
----------------------------	------	------	-----------------------------------



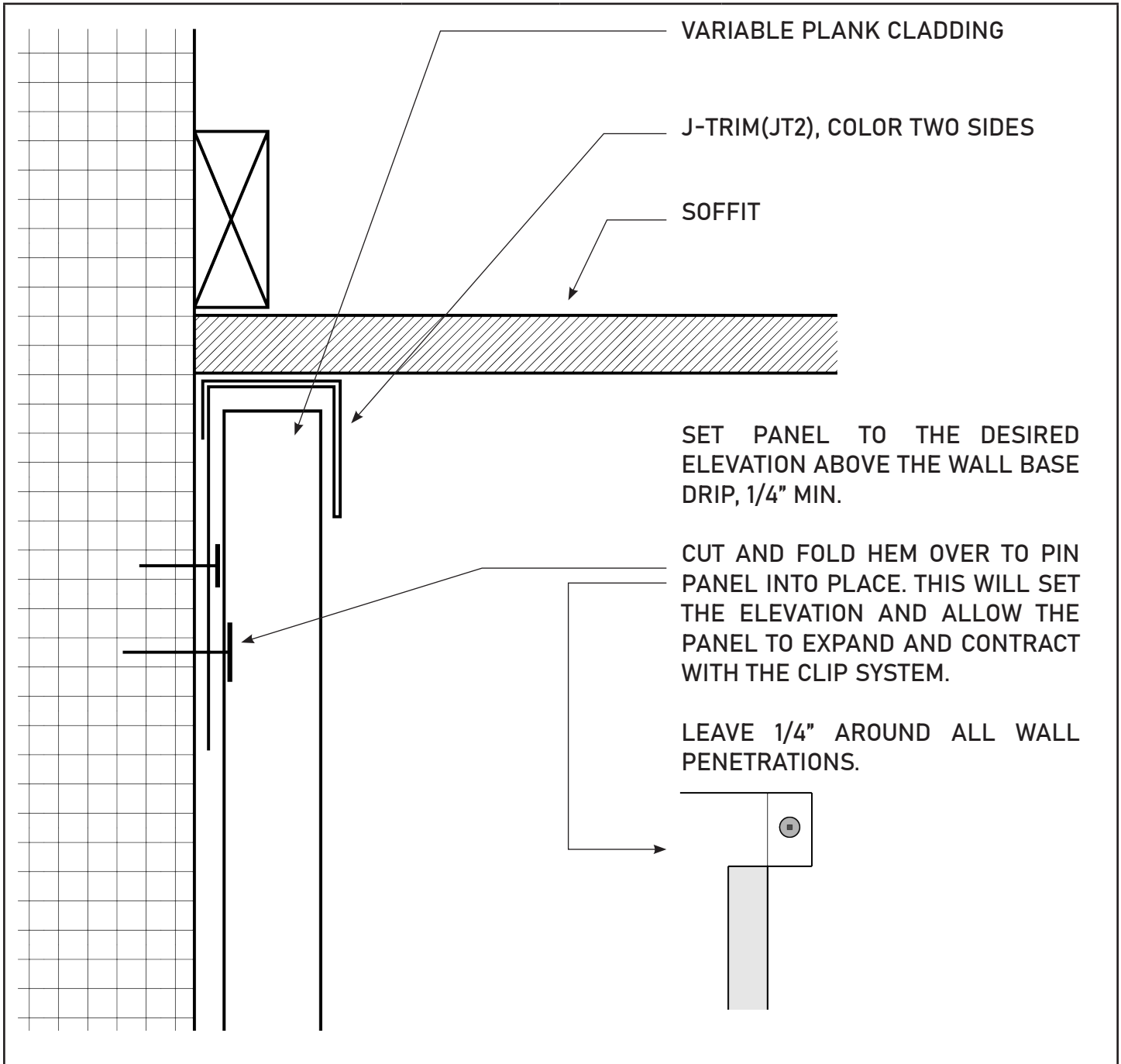

**Notes:**

- Detail is not to scale.
- Wall plane must be level and plumb.
- Fastening clip recommended spacing is 24" on center.
- It is the responsibility of the installer to follow all applicable building codes.
- If J trim is to be used for top and bottom of panel it is recommended to use a EZLOK J for one side to fit in the panel.

TOP OF WALL FLASHING	VP-2	2023	WESTFORM METALS VARIABLE PLANK
-------------------------	------	------	-----------------------------------

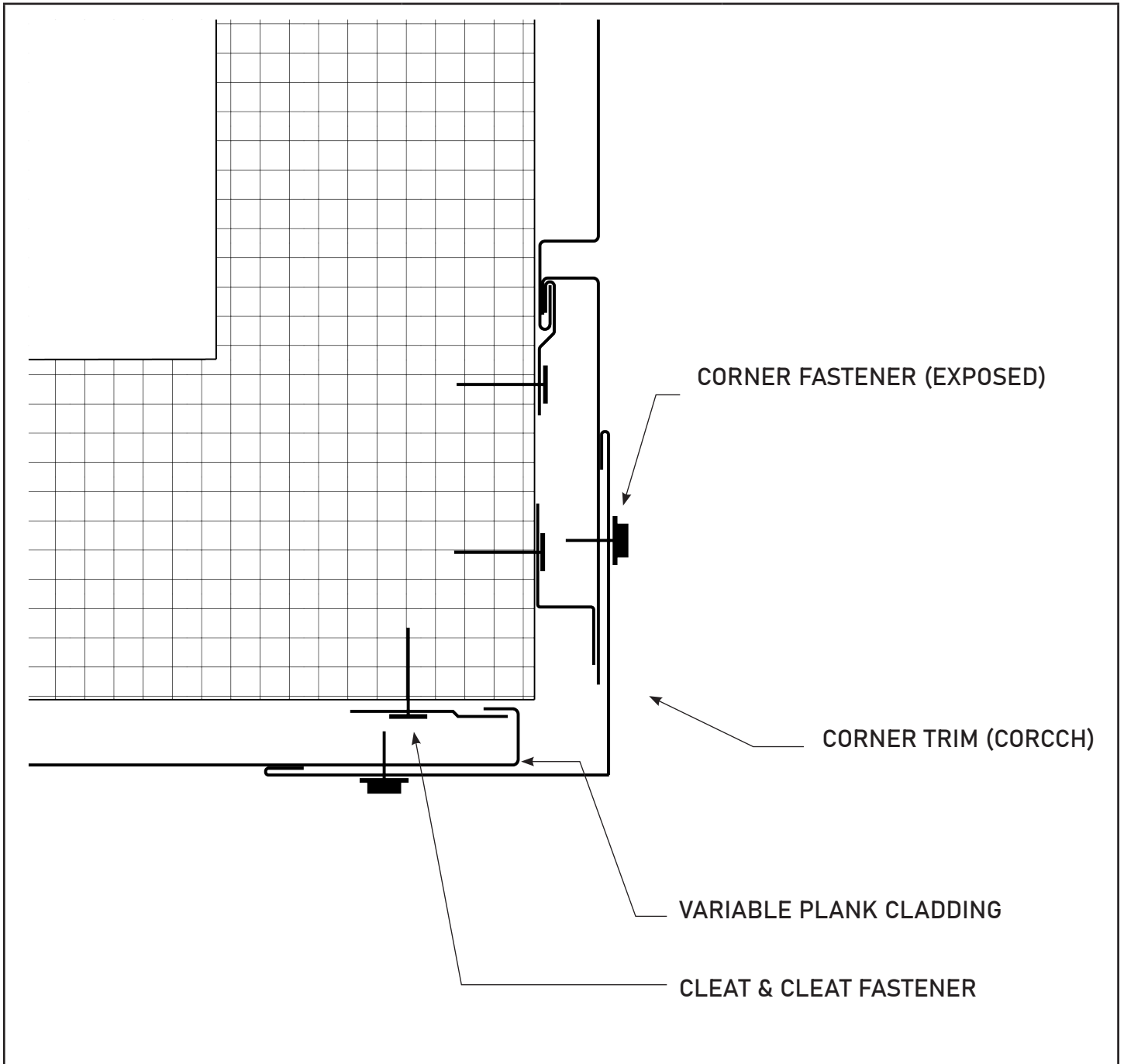

**Notes:**

- Detail is not to scale.
- Wall plane must be level and plumb.
- Fastening clip recommended spacing is 24" on center.
- It is the responsibility of the installer to follow all applicable building codes.

<p><b>OUTSIDE CORNER (EXPOSED FASTENER)</b></p>	<p>VP-3</p>	<p>2023</p>	<p><b>WESTFORM METALS VARIABLE PLANK</b></p>
---	-------------	-------------	--

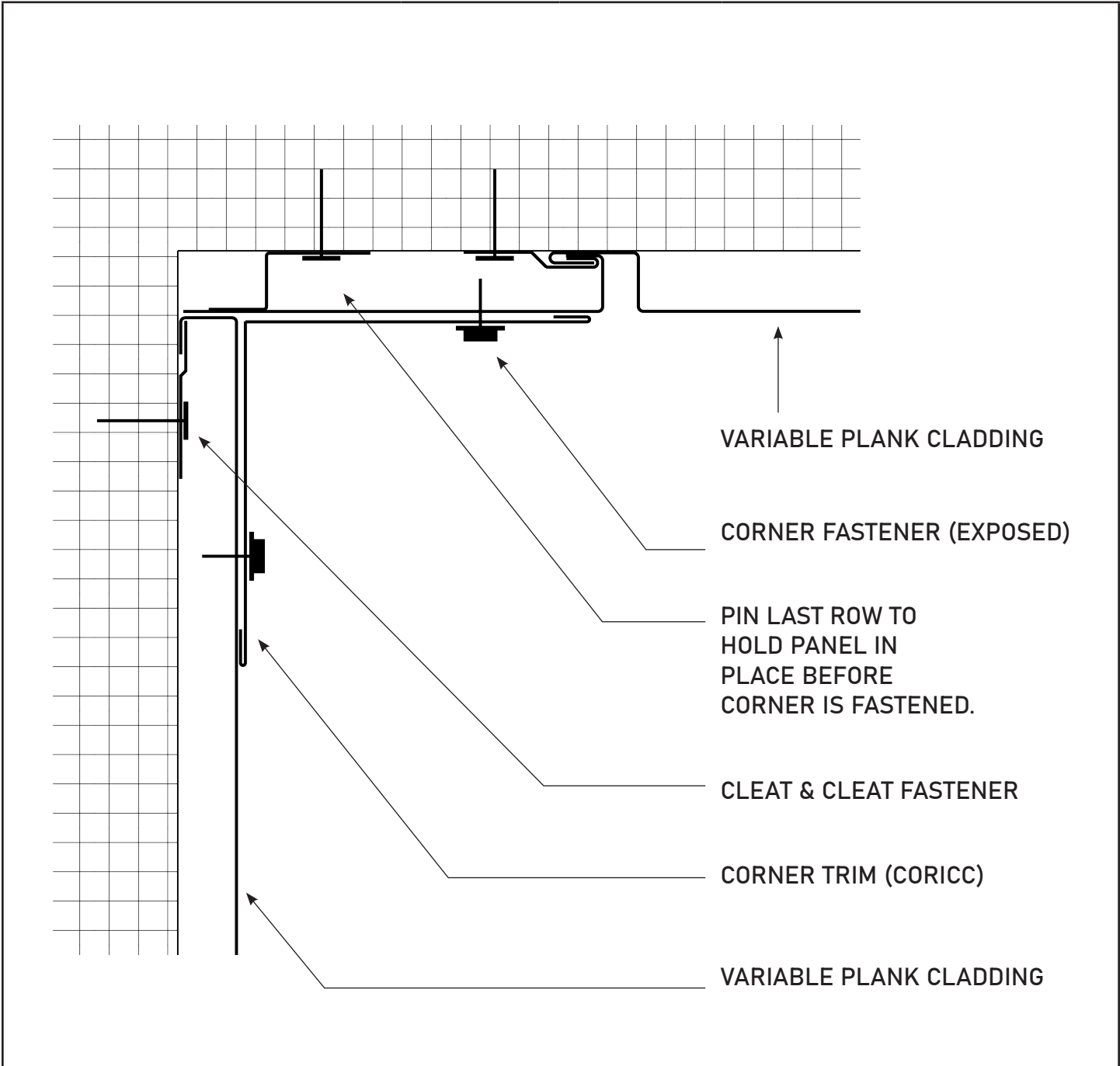

**Notes:**

- Detail is not to scale.
- Wall plane must be level and plumb.
- Fastening clip recommended spacing is 24" on center.
- It is the responsibility of the installer to follow all applicable building codes.

INSIDE CORNER (EXPOSED FASTENER)	VP-4	2023	WESTFORM METALS VARIABLE PLANK
-------------------------------------	------	------	-----------------------------------



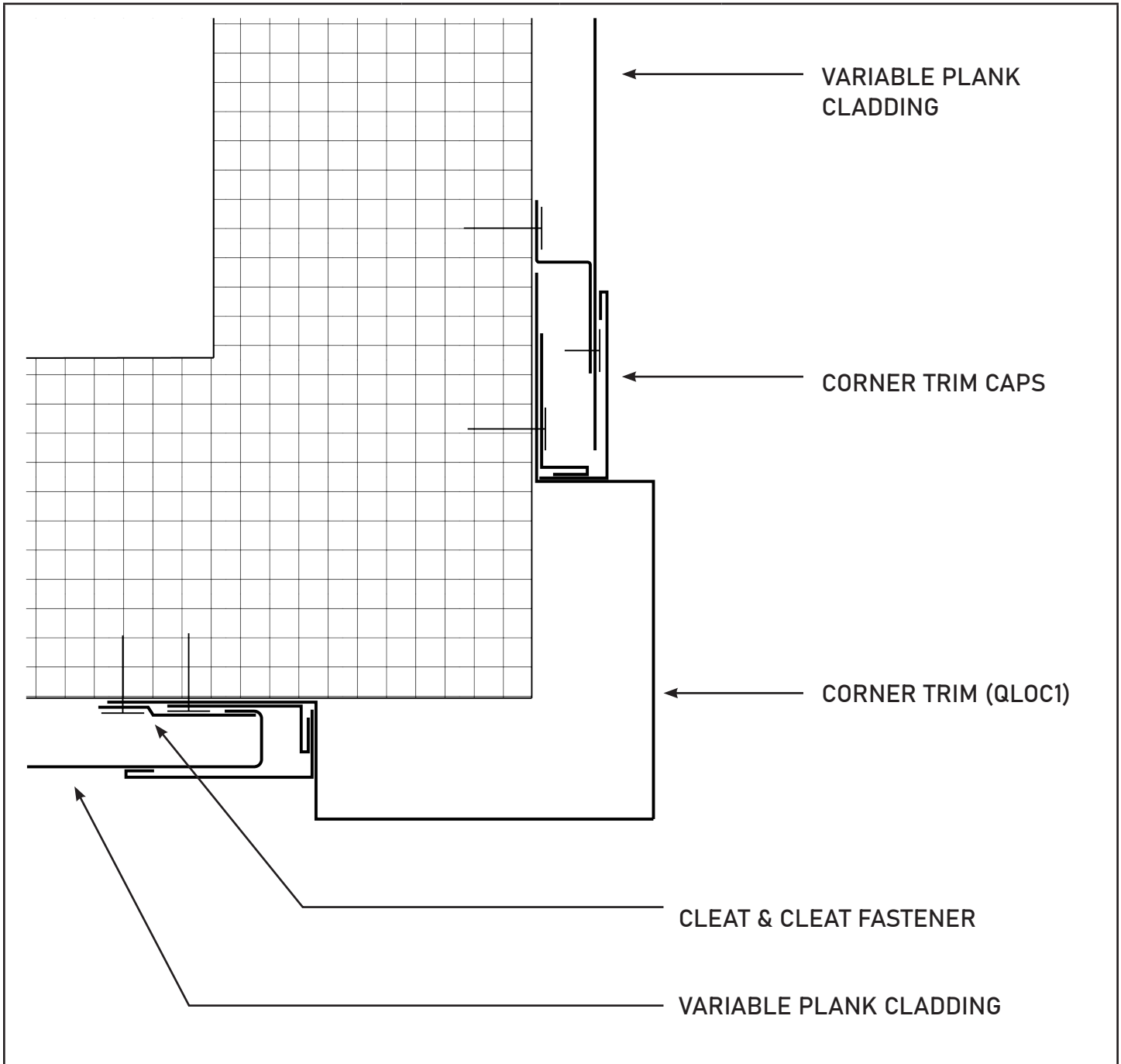

**Notes:**

- Detail is not to scale.
- Wall plane must be level and plumb.
- Fastening clip recommended spacing is 24" on center.
- It is the responsibility of the installer to follow all applicable building codes.

<b>OUTSIDE CORNER (HIDDEN FASTENER)</b>	VP-5	2023	<b>WESTFORM METALS VARIABLE PLANK</b>
---	------	------	---

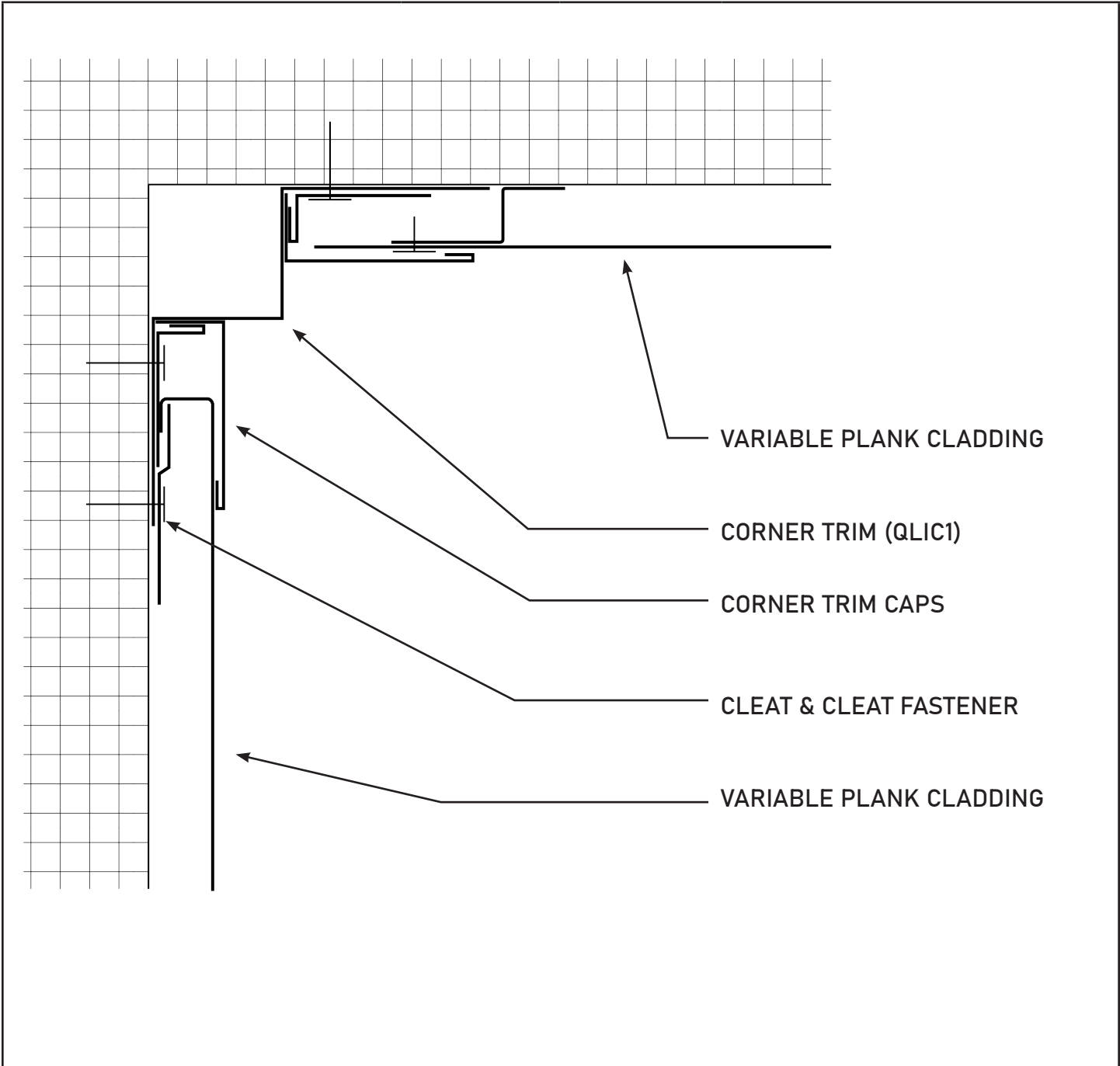

**Notes:**

- Detail is not to scale.
- Wall plane must be level and plumb.
- Fastening clip recommended spacing is 24" on center.
- It is the responsibility of the installer to follow all applicable building codes.

INSIDE CORNER (HIDDEN FASTENER)	VP-6	2023	WESTFORM METALS VARIABLE PLANK
------------------------------------	------	------	-----------------------------------

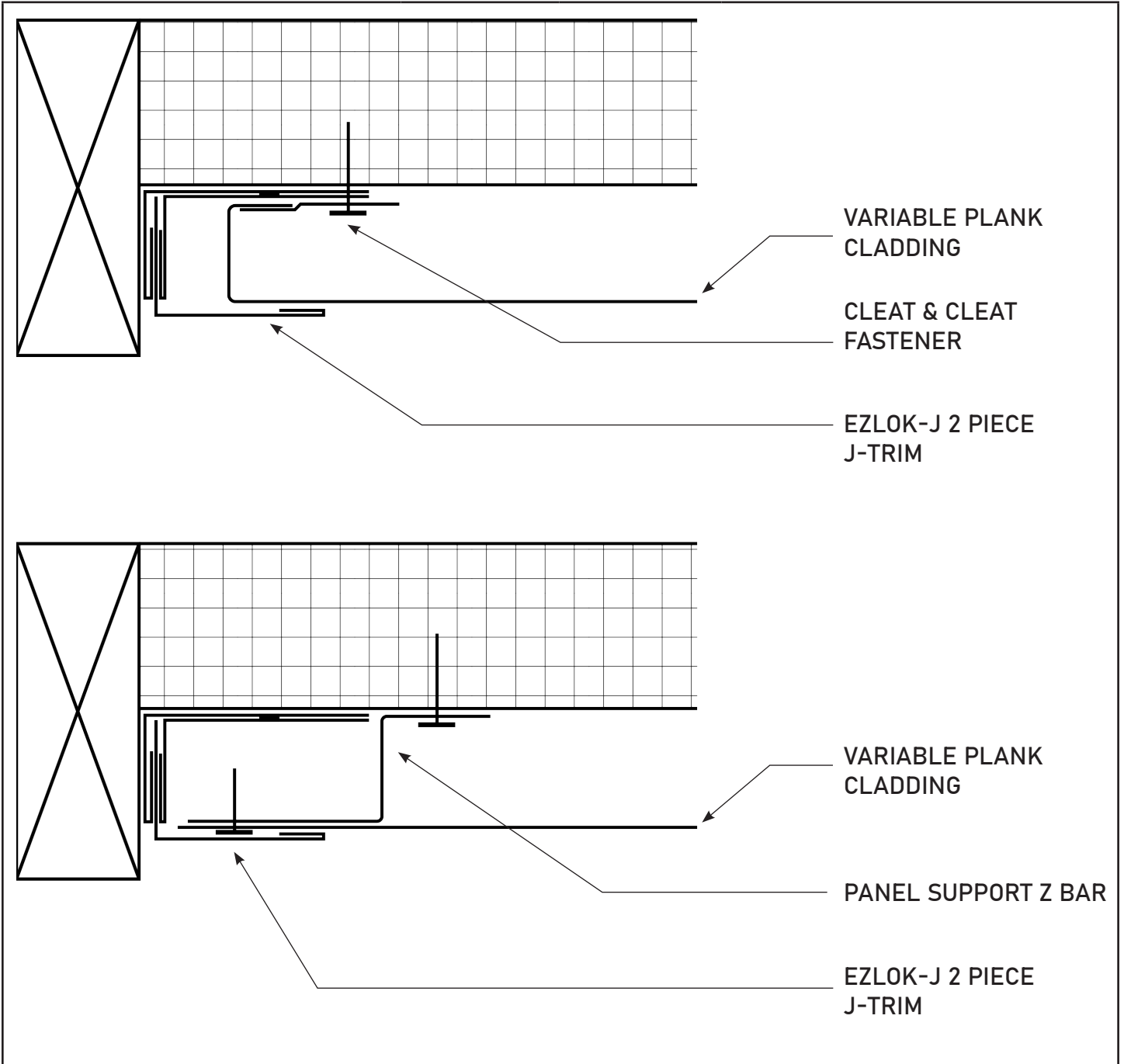

**Notes:**

- Detail is not to scale.
- Wall plane must be level and plumb.
- Fastening clip recommended spacing is 24" on center.
- It is the responsibility of the installer to follow all applicable building codes.

WINDOW/DOOR JAMB	VP-7	2023	WESTFORM METALS VARIABLE PLANK
------------------	------	------	-----------------------------------

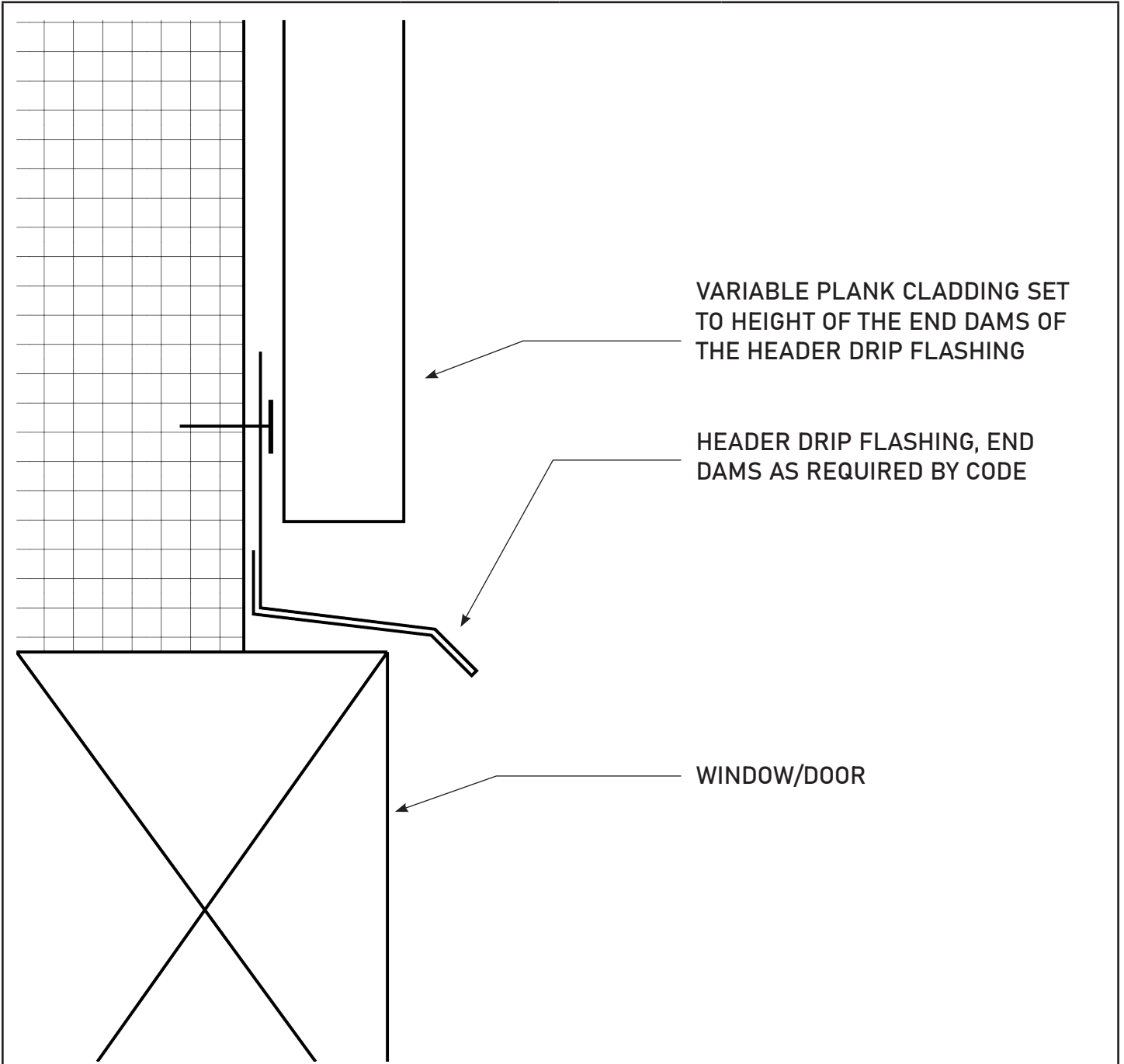

**Notes:**

- Detail is not to scale.
- Wall plane must be level and plumb.
- Fastening clip recommended spacing is 24" on center.
- It is the responsibility of the installer to follow all applicable building codes.
- If J trim is to be used for top and bottom of panel it is recommended to use a EZLOK J for one side to fit in the panel.

<p><b>WINDOW/DOOR HEADER OPTION A</b></p>	<p>VP-8</p>	<p>2023</p>	<p><b>WESTFORM METALS VARIABLE PLANK</b></p>
---	-------------	-------------	--

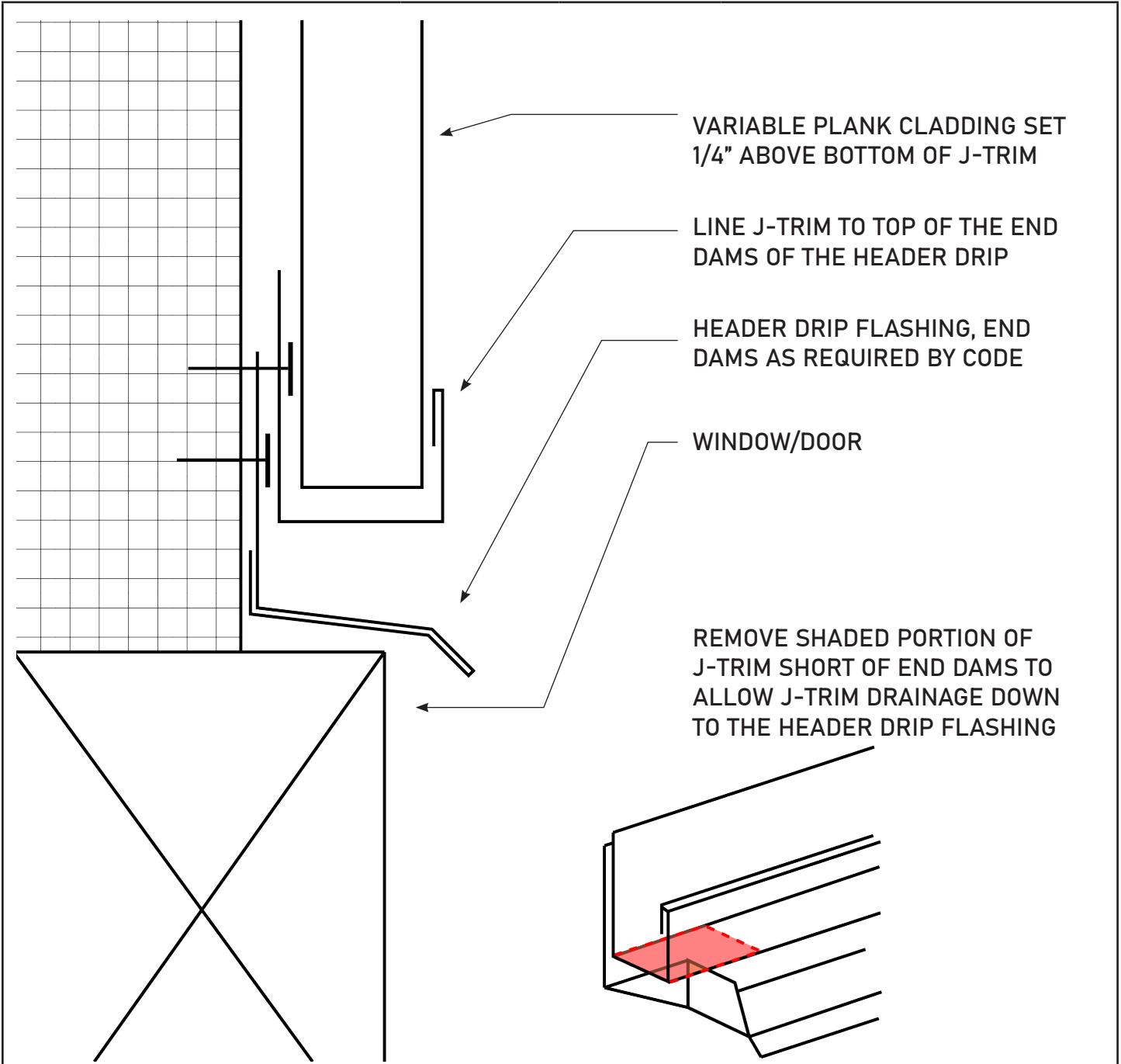

**Notes:**

- Detail is not to scale.
- Wall plane must be level and plumb.
- Fastening clip recommended spacing is 24" on center.
- It is the responsibility of the installer to follow all applicable building codes.
- If J trim is to be used for top and bottom of panel it is recommended to use a EZLOK J for one side to fit in the panel.

<p><b>WINDOW/DOOR HEADER OPTION B</b></p>	<p>VP-9</p>	<p>2023</p>	<p><b>WESTFORM METALS VARIABLE PLANK</b></p>
---	-------------	-------------	--

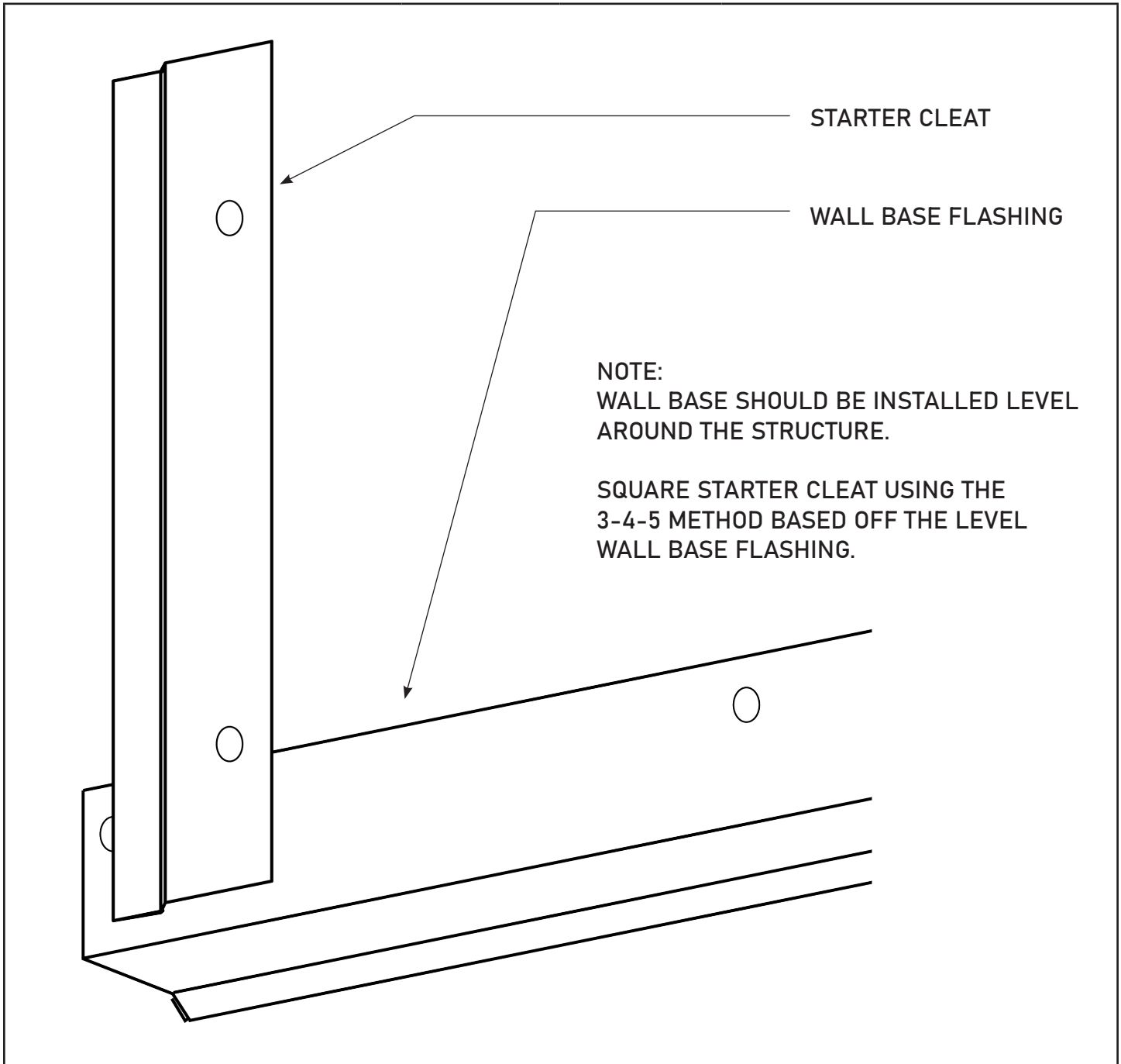

Notes:

- Detail is not to scale.
- Wall plane must be level and plumb.
- Fastening clip recommended spacing is 24" on center.
- It is the responsibility of the installer to follow all applicable building codes.

STARTING CLEAT	VP-10	2023	WESTFORM METALS VARIABLE PLANK
----------------	-------	------	-----------------------------------



## ACCESSORIES

BERMUDA CLIP

\$ EACH

FASTENERS PER THOUSAND

#10 x 1" ACQ PANHEAD QUAD DRIVE. . . . .	\$
#10 x 1" PANHEAD SELF DRILLER. . . . .	\$
#10 x 1" COL. . . . .	\$
#10 x 1.5" COL. . . . .	\$
#14 x 1.25" COL. . . . .	\$
#14 x 7/8" STITCH COL. . . . .	\$

LENGTH: 5' - 26'

STANDARD PROFILE WEIGHTS:

24ga - 1.33 lbs. / LINEAL FT.

22ga - 1.67 lbs. / LINEAL FT.

**OIL-CANNING IS A  
PHENOMENON THAT CAN  
OCCUR ON FLAT METAL AND IS  
NOT A JUST CAUSE FOR  
MATERIAL REJECTION.**

CONSULT YOUR SALES REP FOR  
BEST INSTALLATION PRACTICES

### NOTE:

VARIABLE PLANK LENGTHS  
MUST BE ORDERED IN MULTI-  
PLES.

VP-12" MULTIPLES OF 3  
VP-8" MULTIPLES OF 4  
VP-4.5" MULTIPLES OF 5

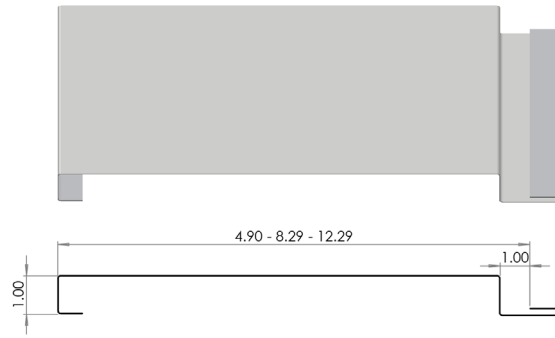

## SMP COLORS & GAUGES (SEE NET PRICE PAGE)

Polar White - 24, 22	Cashmere - 24, 22	Slate Blue - 24, 22
Cambridge White - 24, 22	Antique Linen - 24	Sapphire Blue - 24
White White - 24, 22	Wicker - 24	Mist Green - 24
Brite White - 24	Briarwood Tan - 24	Sage Green - 24
Bone White - 24, 22	Tan - 24, 22	Turquoise - N/A
Surf White - 24, 22	Buckskin - N/A	Pacific Turquoise - 24
Stone Grey - 24, 22	Gold - 24	Deep Water Green - 24
Regent Grey - 24, 22	Sportsman Yellow - N/A	Forest Green - 24
Pebblestone - N/A	Brite Red - 24	Spruce Green - 24
Charcoal Grey - 24, 22	Dark Red - 24	Melchers Green - 24
Black - 24, 22	Tile Red - 24	Dark Green - 24
Black Coffee - 24	Burgundy - 24	Iron Ore - 24, 22
Metro Brown - 24, 22	Labrador Blue - 24	Brite Green - N/A
Dark Brown - 24, 22	Heron Blue - 24	Int. Orange - 24
Ivory - N/A	Royal Blue - 24	

## SMP TEX™ COLORS & GAUGES (SEE NET PRICE PAGE)

Burnished Slate - 24	Kona Brown - 24
Graphite - 24	Black Onyx - 24

## PVDF COLORS & GAUGES (SEE NET PRICE PAGE)

Regal White - 24, 22	Terra Cotta - 24, 22	Twilight Blue - 24
Parchment - 24, 22	Colonial Red - 24	Tahoe Blue - N/A
Sierra Tan - 24	Retro Red - 24	Regal Blue - 24, 22
Champagne Metallic - 24, 22	Hemlock Green - 24	Weathered Zinc - 24, 22
Mocha - 24	Dark Green - N/A	Old Town Grey - 24, 22
Weathered Copper - 24	Forest Green - 24	Old Zinc Grey - 24, 22
Bronze - 24	Hartford Green - 24	Slate Grey - 24, 22
Dark Bronze - 24, 22	Low Gloss Black - 24, 22	
Copper Penny - 24, 22	Silver Metallic - 24, 22	

## PRINTED COLORS & GAUGES (SEE NET PRICE PAGE)

PVDF	PVDF	PE
Acorn - 24	Frontier - 24	Ashwood - 24
Aged Copper - 24	Gunstock - 24	Concrete - 24
Autumn - 24	Homestead - 24	Corten - 24
Barn Board - 24	Light Zinc - 24	Knotty Pine - 24
Birch - 24	Ponderosa - 24	Light Pine - 24
Canyon - 24	Rustic Red - 24	Mesquite - 24
Dark Zinc - 24	Saddle - 24	
Durango - 24	Wagonwood - 24	
Espresso - 24		

## PLAIN/INTERIOR STOCK & GAUGES

Interior Liner Brite White - N/A	Galvanized/Galvalume - N/A
----------------------------------	----------------------------

TERMS Net 30 Days. Prices subject to change without notice.

# RECOMMENDED FLASHINGS

ROOF FLASHINGS WILL BE 4/12 PITCH UNLESS OTHERWISE SPECIFIED

**STARTER CLEAT**  
CLEAT

3/4" 1/2" 2"

**4"**

**WALL BASE**  
636DC

BENT AT 5° SLOPE

3-1/4" 1-3/4" 1/2"

**6"**

**HEADER**  
636HD

BENT AT 5° SLOPE  
COLOR 2 SIDE

3" 1-3/4" 1/2" 1-1/2"

**9"**

**WALL TRANSITION**  
SWWT

3" 1-1/8" 1" 1-1/8"

**9"**

**J TRIM 2**  
PRJT2

COLOR 2 SIDE

3" 1" 1-1/8" 1/2"

**9"**

**EZLOK J 1"**  
EZJ1

ASSEMBLED

1-1/2" 1/2" TOP CAP  
2" BASE

**EZLOK T 1"**  
EZT1

ASSEMBLED

2" 1/2" TOP CAP  
4" BASE

**1/S CORNER CAP**  
CORICC

EXPOSED FASTENER CORNER

1/2" 4" 4"

**9"**

**O/S CORNER CAP**  
CORCCH

EXPOSED FASTENER CORNER

1/2" 4" 4"

**9"**

**1/S CORNER**  
QLIC1

HIDDEN FASTENER CORNER  
NON-ASSEMBLED

1-1/2" 1-1/2" 2-1/2" 1-1/2"

**O/S CORNER**  
QLOC1

HIDDEN FASTENER CORNER  
NON-ASSEMBLED

2-1/2" 1-1/2" 1-1/2" 1-1/2" 3"

**#12 STITCH SCREW**  
S12S100(color)

**#10 PANHEAD DRILLER**  
S10PD100GA

**#10 ACQ PANHEAD**  
S12T100ACQ

**2" BERMUDA WALL CLIP**  
HF-CLIP

SCREWS NOT INCLUDED

WIDTH	GALV / LUME 26 GAUGE	SMP 26 GAUGE	PVDF 26 GAUGE	GALV / LUME 24 GAUGE	SMP 24 GAUGE	PVDF 24 GAUGE
4"	\$	\$	\$	\$	\$	\$
6"	\$	\$	\$	\$	\$	\$
9"	\$	\$	\$	\$	\$	\$
12"	\$	\$	\$	\$	\$	\$
15"	\$	\$	\$	\$	\$	\$
18"	\$	\$	\$	\$	\$	\$
24"	\$	\$	\$	\$	\$	\$
EZLOK J .75	N/A	N/A	N/A	N/A	\$	\$
EZLOK T .75	N/A	N/A	N/A	N/A	\$	\$
QLIC.75	\$	\$	\$	\$	\$	\$
QLOC.75	\$	\$	\$	\$	\$	\$

TERMS NET 30 DAYS. PRICES SUBJECT TO CHANGE WITHOUT NOTICE.